

# The Corner

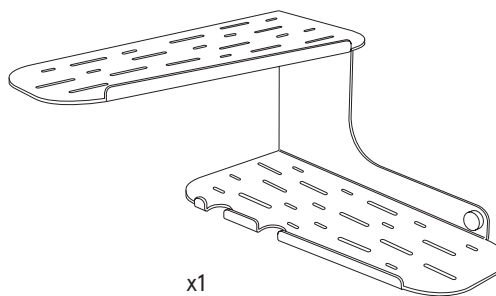

**A** x3 Square-head screws



**B** x3 Threaded sleeves



**C** x3 End caps

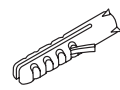

**D** x3 Wall plugs

## INSTALLATION STEPS

1. Choose the location of shelf in the corner.

⚠ Make sure you have a solid fixing point at each screw connection. If you have no solid fixing where the screw connects to the wall, you will need to use the wall plugs provided.

2. Hold your shelf up to the desired position, tight in the corner and place a spirit level on top.

3. Using a pen/pencil mark on the wall through the centre of all three pre-drilled holes.

4. Take the shelf off the wall.

5. Using a 3mm drill bit, drill into the marks you've made on the wall. If drilling through tiles, a 4.5mm bit will be required to pre-drill the depth of the tile.

⚠ **\*\*USING WALL PLUGS?** Drill into your 3mm holes with a 6mm drill bit, fit the wall plugs **D** inside and proceed.

⚠ **\*\*FIXING TO WET AREA?** Fill pre-drilled holes with silicone/sealant before fixing the shelf to the wall.

6. Hold the shelf up to the wall so the holes line up.

7. Put the screw **A** through the threaded sleeve **B** and with a square-head screw driver, screw **A** into the wall, fixing the shelf. Repeat this process with the remaining holes.

8. Finally hand screw on the end caps **C** onto the threaded sleeves **B**.

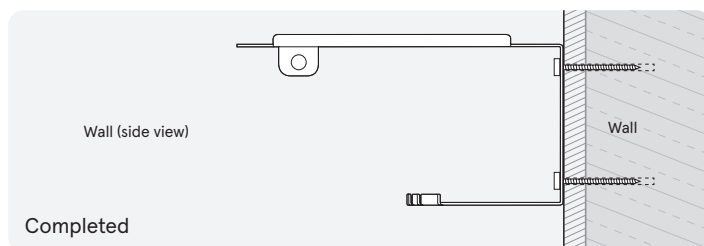
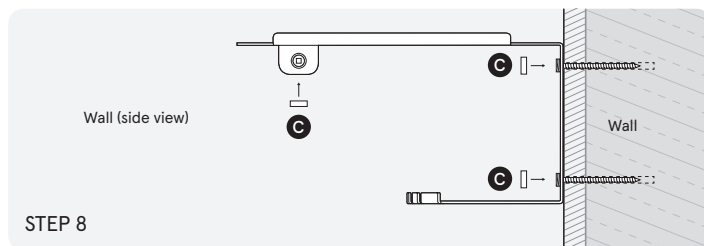
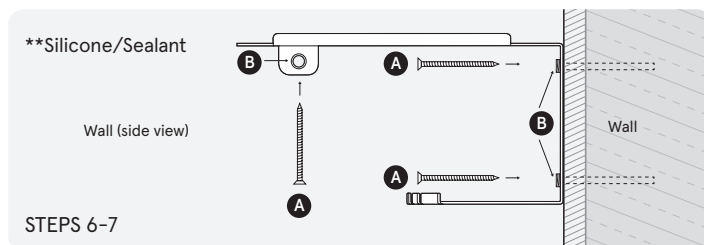
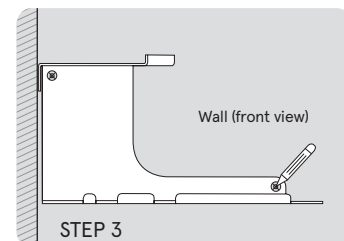
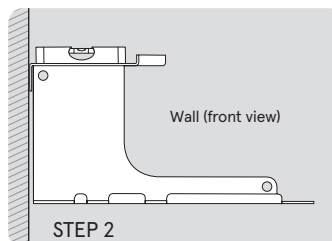

Level



Pencil / Pen



4.5mm



3mm



6mm\*



Electric drill

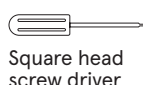

Square head screw driver

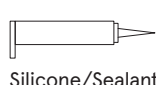

Silicone/Sealant\*\*

\*Optional depending on fixing point.

For best installation results, we recommend using a qualified builder or professional installer.

**CLEANING & CARE** We recommend cleaning The Corner weekly to stop soap scum build up.